

AEL-B300

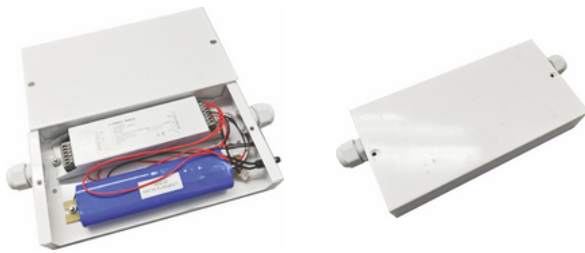

Wiring Diagram

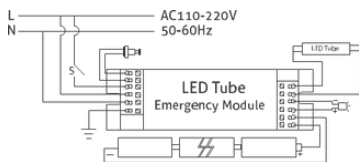

- Compact Design
- Lumen output 140lm
- LifePO4 12.8V 3000mAh
- Working temperature : -5~40



Technical Specifications

MODEL NO :	AEL-B300
Applicable LED Power :	15W
LED Driver :	Internal
Input Voltage :	220-240 V AC
Output Voltage :	220-320V
Operating Temp C :	25 below 0 to 70
Emergency Time :	2 hrs
Start- Up Charging Time :	24 hrs
Brightness Factor :	100%
Protection Device :	Over-Charge, Discharge and Short Circuit Protection
LED Indicator & Test Switch :	Yes
Modules Lifetime :	500 charging cycle
Battery Type/Capacity :	LifePO4 12.8V 3000mAh
Dimension (LxWxH) in mm :	200Lx100Wx40H
Weight (g) :	1300 g
Compliance & Standard :	EN61347-2-13:2006 EN61347-1:2008 A1:1011A2:2013 EN55015:2013 EN61547:2009 EN61000-3-2:2006 A2:2009 EN61000-3-3:2013
Waranty (years) :	3 years

AEL-B400

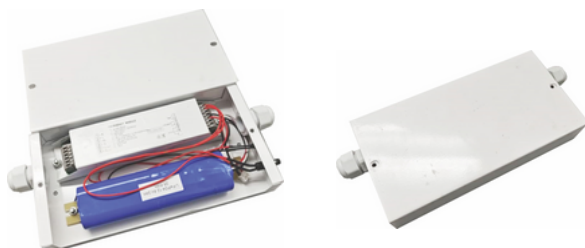

Wiring Diagram

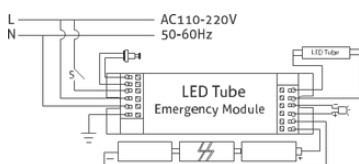

- Compact Design
- Lumen output 140lm
- LifePO4 12.8V 4000mAh
- Working temperature : -5~40



Technical Specifications

MODEL NO :	AEL-B400
Applicable LED Power :	20W
LED Driver :	Internal
Input Voltage :	220-240 V AC
Output Voltage :	220-320V
Operating Temp C :	25 below 0 to 70
Emergency Time :	2 hrs
Start- Up Charging Time :	24 hrs
Brightness Factor :	100%
Protection Device :	Over-Charge, Discharge and Short Circuit Protection
LED Indicator & Test Switch :	Yes
Modules Lifetime :	500 charging cycle
Battery Type/Capacity :	LifePO4 12.8V 4000mAh
Dimension (LxWxH) in mm :	200Lx100Wx40H
Weight (g) :	1300 g
Compliance & Standard :	EN61347-2-13:2006 EN61347-1:2008 A1:1011A2:2013 EN55015:2013 EN61547:2009 EN61000-3-2:2006 A2:2009 EN61000-3-3:2013
Waranty (years) :	3 years